



ADDENDUM NO. 1

RFB#8517 LDLD Road Rehabilitation Project

Receipt of this addendum must be acknowledged in the space provided in the cost response form.



DATE: 10/20/2025

BY

Scott A. Mueller

SCOTT MUELLER
PROJECT ENGINEER

This Addendum No. 1 shall be incorporated into and made part of the above referenced contract documents for RFB#8517.

Addendum Item	Section and Page or Drawing No.	Location and Description of Change
1.01	Volume 2 of 2 Drawing GI002	ADD Drawing GI002 SURVEY MONUMENT DATA with attached Addendum 1 drawing dated 10/20/25 to the drawing set. This drawing includes survey requirements and project information.
1.02	Volume 2 of 2 Drawing C-501	REPLACE Drawing C-501 DETAILS with attached Addendum 1 drawing dated 10/20/25.

10/20/2025

RFB#8517

Addendum No. 1



1.03	Volume 2 of 2 Drawing CG101	REPLACE Drawing CG101 PLAN-UTILITIES AREA A with attached Addendum 1 drawing dated 10/20/25.
1.04	Volume 2 of 2 Drawing CG103	REPLACE Drawing CG103 PLAN-UTILITIES AREA C with attached Addendum 1 drawing dated 10/20/25.
1.05	Volume 2 of 2 Drawing C-402	REPLACE Drawing C-402 INTERSECTION PARTIAL PLAN 2 with attached Addendum 1 drawing dated 10/20/25.
1.06	Volume 1 of 2 Specification 01 14 16/1.03/C.	DELETE “the ELECTRONIC COMMUNICATION PROTOCOLS Section (01 31 26)” and REPLACE with “Section 5-8 of the Sacramento County Standard Construction Specifications”.
1.07	Volume 1 of 2 Specification 01 57 23/1.01/G.	DELETE “the PROGRESS PATMENT PROCEDURES Section (01 29 76)” and REPLACE with “Section 8 of the Sacramento County Standard Construction Specifications”.
1.08	Volume 1 of 2 Specification 01 57 23/1.03/A.	DELETE “the SUBMITTAL PROCEDURES Section (01 33 00)” and REPLACE with “Section 5-8 of the Sacramento County Standard Construction Specifications”.
1.09	N/A	Attached please find the responses to Contractor Questions received to date.

10/20/2025

RFB#8517

Addendum No. 1

Questions and Answers

RFB#8517 LDLD Road Rehabilitation Project

1. Does the District have an erosion control plan for the project? Looking for clarification on what BMPs will be required for the project, for example check dams, inlet protection, fiber rolls along both sides of the roadways, ESA fence, and etc.

Please direct your attention to Part B - Specifications/Section 01 57 23 Temporary Storm Water Pollution Control. This project is fully within the EchoWater Resource Recovery Facility, and the project area has roadside ditches and land disposal basins that either collect water and settles out in place or flows back to the headworks of the EchoWater Facility for treatment. The project area has no habitat land cover types used by sensitive species. The Contractor shall implement Best Management Practices to prevent the direct and indirect contribution of any excessive sediment or contaminant into the roadway ditches and basins.

2. Will delivery truck drivers (cement/aggregate base) require badging or an escort while onsite?

No, delivery drivers will not require badges, however the Contractor will need to escort the drivers to the site. Returning drivers that know the route will not have to be escorted each time.

3. Can the Contractor utilize recycled aggregate base for this project or will virgin material be required as indicated per the County Specifications.

Recycled Aggregate Base material is allowed in the Sacramento County Specifications.

4. Who is responsible for the compaction testing of the subgrade and aggregate base? County Standards indicate the owner is responsible.

Per the Sacramento County Specifications, the Contractor is responsible for Quality Assurance (QA) and the District (County CMID Lab) will be responsible for the Quality Control (QC).

5. Who is responsible for the survey on the project? County Standards indicate the owner is responsible.

See General Survey Note 1. on Addendum item 1.01.

6. Are there any finish grade requirements to be met to determine if any grading needs to be performed prior to FDR treatment or placing the aggregate base?

See General Survey Note 2. on addendum item 1.01.

7. Will the District provide time extensions due to weather/temperature delays since the project is scheduled to start in December?

Yes, the Sacramento County Standard Construction Specifications address weather delays, and weather events will warrant time extensions.

8. The Plan-Utilities sheets show vast amounts of existing utilities along the project alignment. This could require large quantities of potholing depending on the depths of these existing utilities. Please provide a bid item and quantity for Potholing to bring all the bidders on the same page. If a qty will not be given, please provide as-built profiles that show depths to help us discern the proper number of potholes required. If profiles are not available, please provide a list of the average depths of each type of utility line.

See Underground Utility & Pothole Notes on addendum item 1.03.

9. As brought up in the job walk, please confirm that when Sheet 5of16 says "RAISE EXISTING OR PROVIDE NEW" that we are, for bidding purposes, to provide all NEW.

See General Sheet Note 4 on addendum item 1.02.

10. Please confirm that Sheet 5of16 detail C4 shows that all Hand Hole boxes are to remain in place after the tops are lowered, and that we will be required to provide the following new: a precast Grade Ring, cast in place PCC Collar, and all new Frame and Cover. We are not being asked to provide new HH boxes, correct?

The Hand Hole boxes are to remain in place with the upper portion(Frame & Cover) being raised to grade. The contractor is not being asked to provide new Hand Hole boxes.

11. Please provide Job walk sign in sheet.

Attached.

12. Regarding the KEY ACTION DATES, RFB Pg 5. We are unsure what "Vet Bonds and Insurance" is. Please Advise.

Vetting bonds and insurance simply means that the District will be asking for a contact with the Contractor's surety company to verify the performance and payment bonds comply with the RFB requirements. The insurance certificate will be sent to the District's Risk Management department for review.

13. Can the Pollution Liability requirement be changed to \$1 million instead of \$2 million?

No, the Pollution Liability requirement will not be changed for this project.

Printed Name	Company	Email
Scott Mueller	SacSewer Project Manager	muellers@sacsewer.com
Dan Wilson	SacSewer Project Supervisor	wilsonda@sacsewer.com
Sara Burns	Robert Burns Construction, Inc	Request@robertburns construction.com
Estan Abreo	McGuire & Hester	sacestina.hng@mcguireandhester.com
Patrick Delno	BRCO Constructors	llathrop@gobrco.com mroth@gobrco.com
Ramon Rivera	midland. Const.	si@midlandgrading.com
Mitch Norman	Martin Brothers Construction	Estimating@Martinbrothers.net

Printed Name	Company	Email
MATT O'BRIEN	GHILOTTI CONSTRUCTION COMPANY	annette@ghilotti.com
Kendall Porter	Western Engineering	kporter@westeng.com
Israel Alvarez	Alta Concrete Inc.	Israel@altaconcreteinc.com
Roni Presley	Soracco, Inc.	estimating@soraccoinc.com
Megan Tracy	Goebel Construction Inc.	estimating@mailgci.com
DAVE KOERBER	J D PASQUETTI	ESTIMATING@JDPASQUETTI.COM
Patrick Flood	CMID	FloodP@sccounty.gov
Matt Anderson	R&R Pacific Const	matt@rrpcc.com
Arwaad Muqatash	O.C. Jones and Sons	amuqatash@ocjones.com
Michael Zenk	Teichert	mzenk@teichert.com
Dexter Rogers	Martin General Engineering	estimating@martingeneral.net
Nic Algra	R. J. Gordon Const.	noah@rjgordonconstruction.com

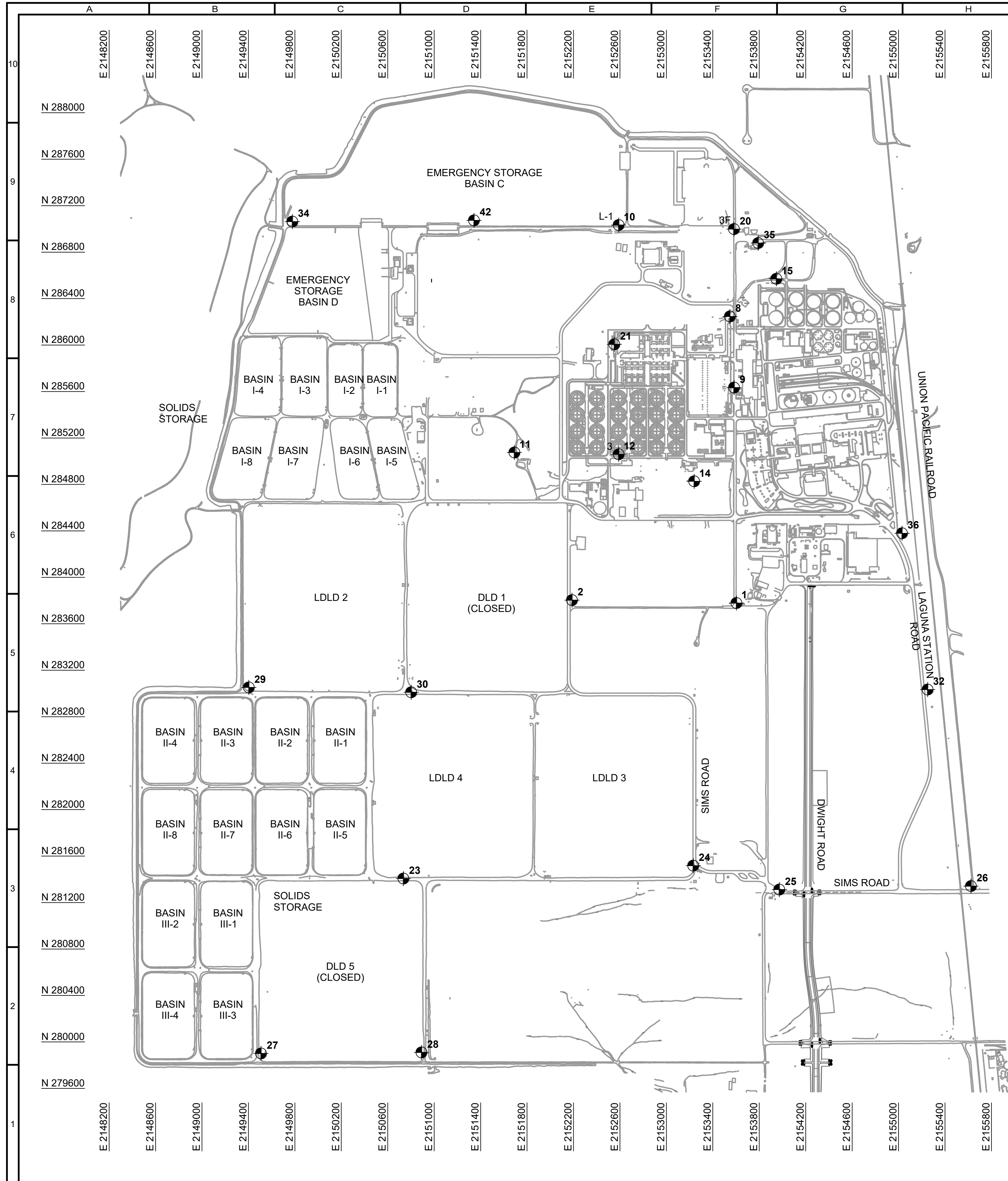

- GENERAL SURVEY NOTES:**
- DELETE SECTION 5-9.01 "AGENCY-FURNISHED SURVEYS" OF THE SACRAMENTO COUNTY STANDARD CONSTRUCTION SPECIFICATIONS. THE CONTRACTOR IS RESPONSIBLE FOR PERFORMING ALL NECESSARY SURVEYS TO LAYOUT AND CONTROL THE WORK.
 - ROADWAY LINE AND GRADE SHOULD GENERALLY MIMIC THE EXISTING ROADWAY CONDITIONS, EXCEPT THAT THE NEW FDR SECTION SHALL BE CONSTRUCTED TO MATCH THE TYPICAL SECTIONS SHOWN ON DRAWING C-301. A FIXED ELEVATION IS NOT REQUIRED, BUT THE FINISHED SUBGRADE ELEVATIONS SHALL BE SIMILAR TO THE EXISTING CONDITION (+/-0.2'). THE CONTRACTOR WILL BE RESPONSIBLE FOR UTILIZING BEST EQUIPMENT GRADING PRACTICES TO PRODUCE SMOOTH, CONSISTANT, STRAIGHT GRADES THAT WILL PRODUCE UNIFORM ROADWAY SURFACES.
 - MONUMENT NUMBERS 3, L-1, 3A, 3B, 3C, 3E, 3F, AND 7 SHALL NOT BE USED.
 - CONTRACTOR SHALL ESTABLISH ADDITIONAL MONUMENTS, AS NEEDED FOR CONTROL OF CONSTRUCTION.
 - ELEVATIONS SHOWN REPRESENT NGVD29 PLUS 100 FEET.
 - CONTRACTOR SHALL NOTIFY THE RESIDENT ENGINEER 48 HOURS IN ADVANCE OF REMOVING OR DESTROYING ANY SURVEY MONUMENT FOR THE PURPOSE OF REFERENCING MONUMENTS OR FOR RE-ESTABLISHING A POINT AFTER WORK IS COMPLETED.
 - THIS DRAWING AND ALL OTHER DRAWINGS USE THE (CA-II) NAD 27 CALIFORNIA STATE PLANE, ZONE II COORDINATE SYSTEM. IF YOU ARE USING NAD83 OR ANY OTHER COORDINATED SYSTEM, PLEASE CONVERT AS NEEDED AND IDENTIFY WHAT SYSTEM ON THE DRAWING.

LEGEND:

	43 NAIL AND SHINER
	23 BRASS DISC

SURVEY GRID MONUMENT DATA

NUMBER	DESCRIPTION	NORTHING	EASTING	ELEVATION
1	SRWTP1 (MONUMENT DESTROYED)	0.0000	0.0000	0.000
2	SRWTP2	283795.5000	2152198.1560	118.006
8	SRWTP8	286237.8450	2153558.6100	120.785
9	SRWTP9	285625.7560	2153594.1320	116.114
10	MONUMENT L-1	287025.3300	2152599.9280	116.339
11	SIMS ROAD	285066.6580	2151701.7890	116.749
12	MONUMENT 3	285050.9380	2152599.9170	115.061
13	MONUMENT DESTROYED	283979.9820	2153799.9170	116.130
14	MONUMENT D-5	284818.7560	2153249.5420	113.728
15	SEC COR MONUMENT 6	286648.2240	2153849.4180	111.910
20	MONUMENT 3F	286990.5363	2153593.4273	116.253
21	PT GREG (REPL 7)	281398.6040	2152562.8710	117.539
23	SRWTP10	281398.6040	2150745.4282	117.427
24	SRWTP11	281509.5693	2153242.0683	117.217
25	SRWTP12	281303.6092	2153983.7623	115.809
26	SRWTP13	281333.2388	2155634.1248	123.600
27	SRWTP14	279892.4228	2149519.5031	117.011
28	SRWTP15	279901.4206	2150901.9228	117.050
29	SRWTP16	283044.0587	2149414.5858	117.315
30	SRWTP17	283002.7927	2150813.0067	116.922
32	SRWTP19	283025.6317	2155261.4072	120.542
34	NOT TO BE USED (FOUND BRASS DISC)	287024.8390	2149746.0020	122.135
35	SRWTP24	286867.7101	2153801.2965	120.518
36	SRWTP25	284371.4608	2155040.8816	115.722
41	MONUMENT DESTROYED	286714.3013	2152976.3935	114.936
42	NOT TO BE USED (FOUND BRASS DISC AT NORTHWEST TOP RAMP SPILLWAY)	287041.3520	2150386.1630	117.310

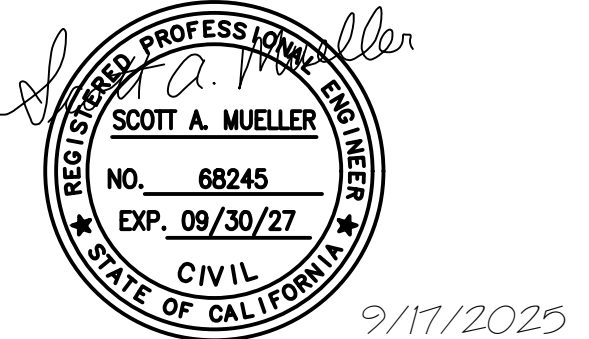
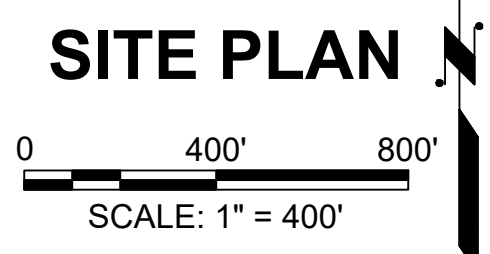

REVISIONS					
ZONE	REV.	DESCRIPTION	BY	DATE	APP.
	1	ADDENDUM #1		10/20/25	

LINE IS 2 INCHES AT FULL SIZE (IF NOT 2" SCALE ACCORDINGLY)
FILE _____
DRAWN SM
DESIGNED SM
CHECKED DTW

RFB 8517

SACRAMENTO AREA SEWER DISTRICT
 ECHOWATER RESOURCE RECOVERY FACILITY
 LDLD ROAD REHABILITATION PROJECT

GENERAL
 SURVEY MONUMENT DATA

SCALE
 NO SCALE
 DRAWING NUMBER
 G1002
 SHEET NUMBER
 4A OF 16

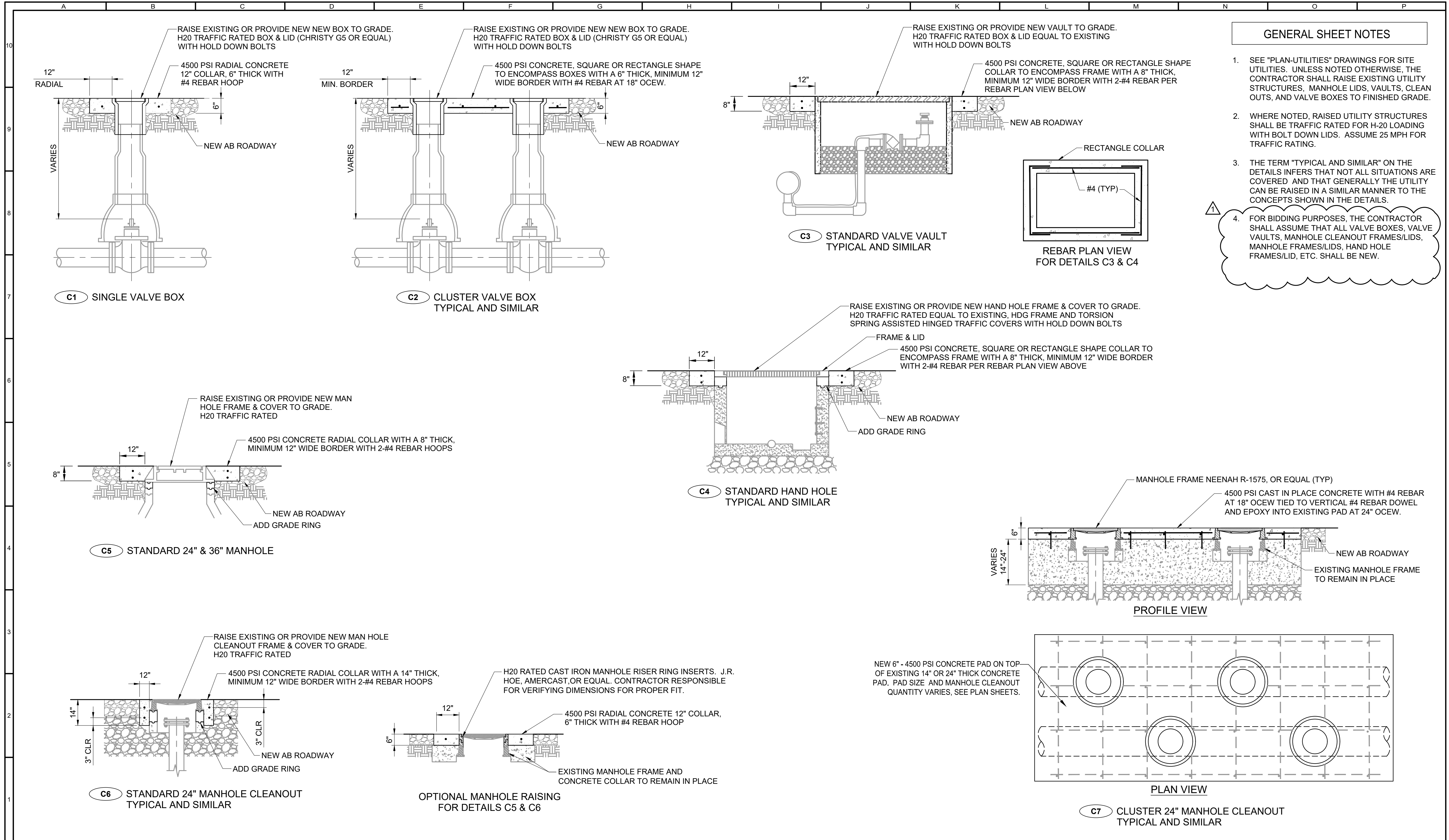

GENERAL SHEET NOTES

- SEE "PLAN-UTILITIES" DRAWINGS FOR SITE UTILITIES. UNLESS NOTED OTHERWISE, THE CONTRACTOR SHALL RAISE EXISTING UTILITY STRUCTURES, MANHOLE LIDS, VAULTS, CLEAN OUTS, AND VALVE BOXES TO FINISHED GRADE.
- WHERE NOTED, RAISED UTILITY STRUCTURES SHALL BE TRAFFIC RATED FOR H-20 LOADING WITH BOLT DOWN LIDS. ASSUME 25 MPH FOR TRAFFIC RATING.
- THE TERM "TYPICAL AND SIMILAR" ON THE DETAILS INFERS THAT NOT ALL SITUATIONS ARE COVERED AND THAT GENERALLY THE UTILITY CAN BE RAISED IN A SIMILAR MANNER TO THE CONCEPTS SHOWN IN THE DETAILS.
- FOR BIDDING PURPOSES, THE CONTRACTOR SHALL ASSUME THAT ALL VALVE BOXES, VALVE VAULTS, MANHOLE CLEANOUT FRAMES/LIDS, MANHOLE FRAMES/LIDS, HAND HOLE FRAMES/LID, ETC. SHALL BE NEW.

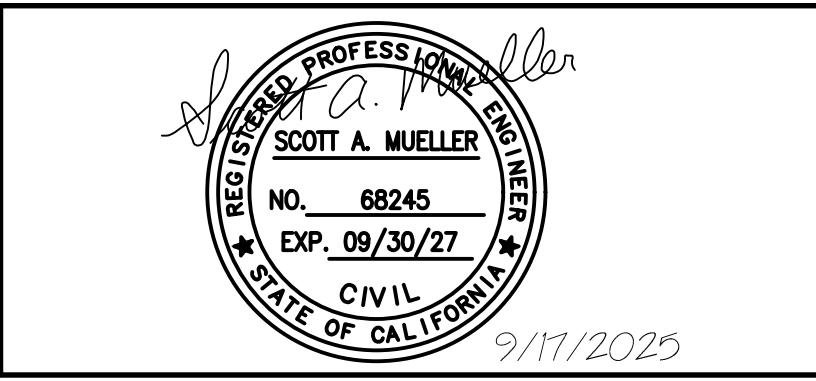

REVISIONS				
ZONE	REV.	DESCRIPTION	BY	DATE
	1	ADDENDUM #1		10/20/25

LINE IS 2 INCHES AT FULL SIZE (IF NOT 2" SCALE ACCORDINGLY)

FILE _____
 DRAWN SM
 DESIGNED SM
 CHECKED DTW

RFB 8517

SACRAMENTO AREA SEWER DISTRICT

ECHOWATER RESOURCE RECOVERY FACILITY
 LDLD ROAD
 REHABILITATION PROJECT

CIVIL
 DETAILS

SCALE
 NO SCALE

DRAWING NUMBER
 C-501

SHEET NUMBER
 5 OF 16

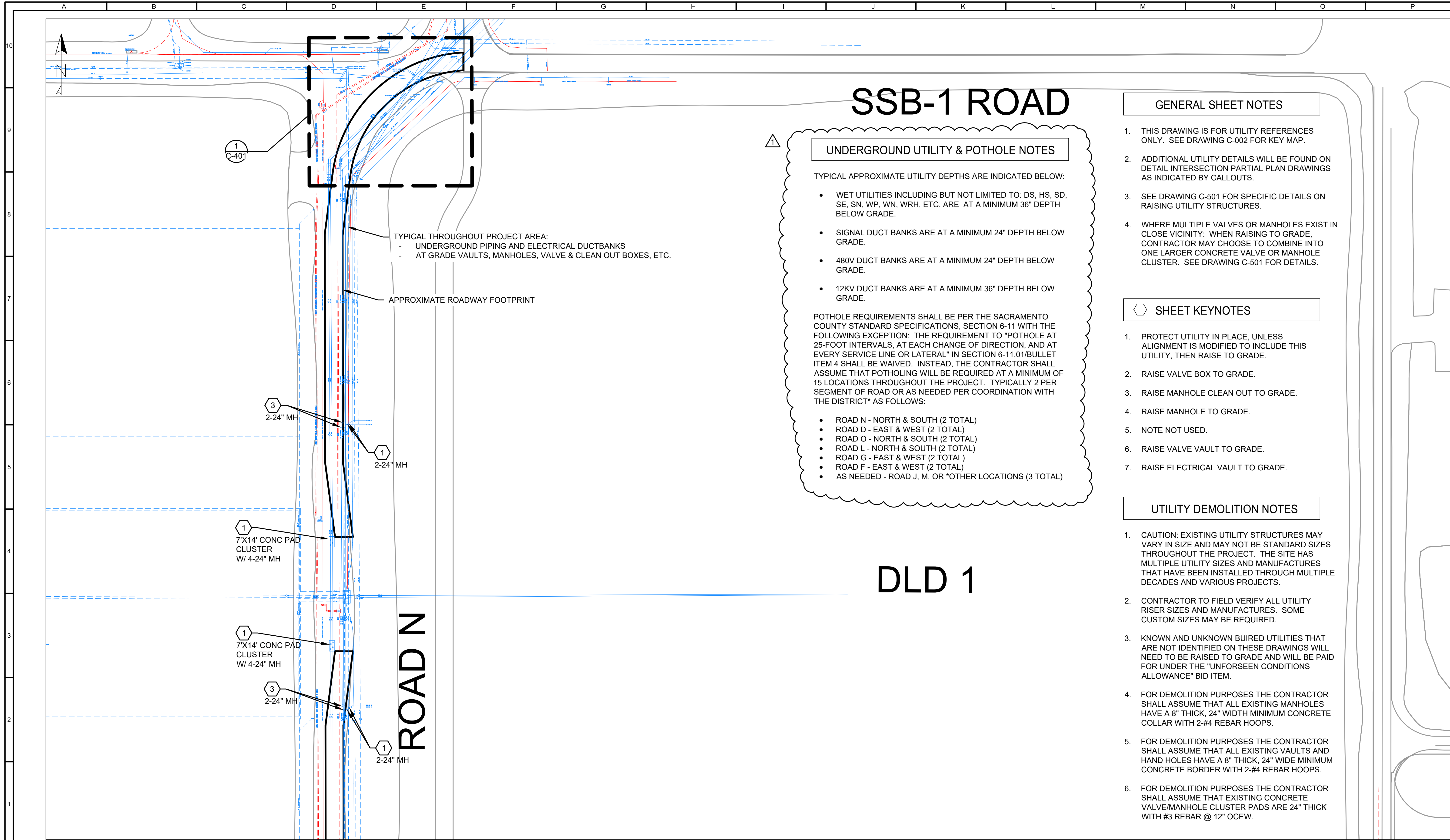

SSB-1 ROAD

UNDERGROUND UTILITY & POT HOLE NOTES

TYPICAL APPROXIMATE UTILITY DEPTHS ARE INDICATED BELOW:

- WET UTILITIES INCLUDING BUT NOT LIMITED TO: DS, HS, SD, SE, SN, WP, WN, WRH, ETC. ARE AT A MINIMUM 36" DEPTH BELOW GRADE.
- SIGNAL DUCT BANKS ARE AT A MINIMUM 24" DEPTH BELOW GRADE.
- 480V DUCT BANKS ARE AT A MINIMUM 24" DEPTH BELOW GRADE.
- 12KV DUCT BANKS ARE AT A MINIMUM 36" DEPTH BELOW GRADE.

POTHOLE REQUIREMENTS SHALL BE PER THE SACRAMENTO COUNTY STANDARD SPECIFICATIONS, SECTION 6-11 WITH THE FOLLOWING EXCEPTION: THE REQUIREMENT TO "POTHOLE AT 25-FOOT INTERVALS, AT EACH CHANGE OF DIRECTION, AND AT EVERY SERVICE LINE OR LATERAL" IN SECTION 6-11.01/BULLET ITEM 4 SHALL BE WAIVED. INSTEAD, THE CONTRACTOR SHALL ASSUME THAT POT HOLLING WILL BE REQUIRED AT A MINIMUM OF 15 LOCATIONS THROUGHOUT THE PROJECT. TYPICALLY 2 PER SEGMENT OF ROAD OR AS NEEDED PER COORDINATION WITH THE DISTRICT* AS FOLLOWS:

- ROAD N - NORTH & SOUTH (2 TOTAL)
- ROAD D - EAST & WEST (2 TOTAL)
- ROAD O - NORTH & SOUTH (2 TOTAL)
- ROAD L - NORTH & SOUTH (2 TOTAL)
- ROAD G - EAST & WEST (2 TOTAL)
- ROAD F - EAST & WEST (2 TOTAL)
- AS NEEDED - ROAD J, M, OR *OTHER LOCATIONS (3 TOTAL)

GENERAL SHEET NOTES

1. THIS DRAWING IS FOR UTILITY REFERENCES ONLY. SEE DRAWING C-002 FOR KEY MAP.
2. ADDITIONAL UTILITY DETAILS WILL BE FOUND ON DETAIL INTERSECTION PARTIAL PLAN DRAWINGS AS INDICATED BY CALLOUTS.
3. SEE DRAWING C-501 FOR SPECIFIC DETAILS ON RAISING UTILITY STRUCTURES.
4. WHERE MULTIPLE VALVES OR MANHOLES EXIST IN CLOSE VICINITY: WHEN RAISING TO GRADE, CONTRACTOR MAY CHOOSE TO COMBINE INTO ONE LARGER CONCRETE VALVE OR MANHOLE CLUSTER. SEE DRAWING C-501 FOR DETAILS.

SHEET KEYNOTES

1. PROTECT UTILITY IN PLACE, UNLESS ALIGNMENT IS MODIFIED TO INCLUDE THIS UTILITY, THEN RAISE TO GRADE.
2. RAISE VALVE BOX TO GRADE.
3. RAISE MANHOLE CLEAN OUT TO GRADE.
4. RAISE MANHOLE TO GRADE.
5. NOTE NOT USED.
6. RAISE VALVE VAULT TO GRADE.
7. RAISE ELECTRICAL VAULT TO GRADE.

UTILITY DEMOLITION NOTES

1. CAUTION: EXISTING UTILITY STRUCTURES MAY VARY IN SIZE AND MAY NOT BE STANDARD SIZES THROUGHOUT THE PROJECT. THE SITE HAS MULTIPLE UTILITY SIZES AND MANUFACTURES THAT HAVE BEEN INSTALLED THROUGH MULTIPLE DECADES AND VARIOUS PROJECTS.
2. CONTRACTOR TO FIELD VERIFY ALL UTILITY RISER SIZES AND MANUFACTURES. SOME CUSTOM SIZES MAY BE REQUIRED.
3. KNOWN AND UNKNOWN BUIED UTILITIES THAT ARE NOT IDENTIFIED ON THESE DRAWINGS WILL NEED TO BE RAISED TO GRADE AND WILL BE PAID FOR UNDER THE "UNFORSEEN CONDITIONS ALLOWANCE" BID ITEM.
4. FOR DEMOLITION PURPOSES THE CONTRACTOR SHALL ASSUME THAT ALL EXISTING MANHOLES HAVE A 8" THICK, 24" WIDTH MINIMUM CONCRETE COLLAR WITH 2-#4 REBAR HOOPS.
5. FOR DEMOLITION PURPOSES THE CONTRACTOR SHALL ASSUME THAT ALL EXISTING VAULTS AND HAND HOLES HAVE A 8" THICK, 24" WIDE MINIMUM CONCRETE BORDER WITH 2-#4 REBAR HOOPS.
6. FOR DEMOLITION PURPOSES THE CONTRACTOR SHALL ASSUME THAT EXISTING CONCRETE VALVE/MANHOLE CLUSTER PADS ARE 24" THICK WITH #3 REBAR @ 12" OCEW.

DLD 1

ROAD N

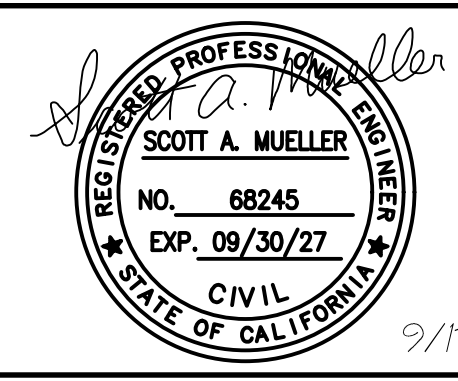

ZONE	REV.	DESCRIPTION	BY	DATE	APP.
	1	ADDENDUM #1		10/20/25	

FILE	
DRAWN	SM
DESIGNED	SM
CHECKED	DTW

RFB 8517

SACRAMENTO AREA SEWER DISTRICT
ECHOWATER RESOURCE RECOVERY FACILITY
LDLD ROAD REHABILITATION PROJECT

CIVIL
PLAN-UTILITIES AREA A

SCALE
1"=60'
DRAWING NUMBER
CG101
SHEET NUMBER
8 OF 16

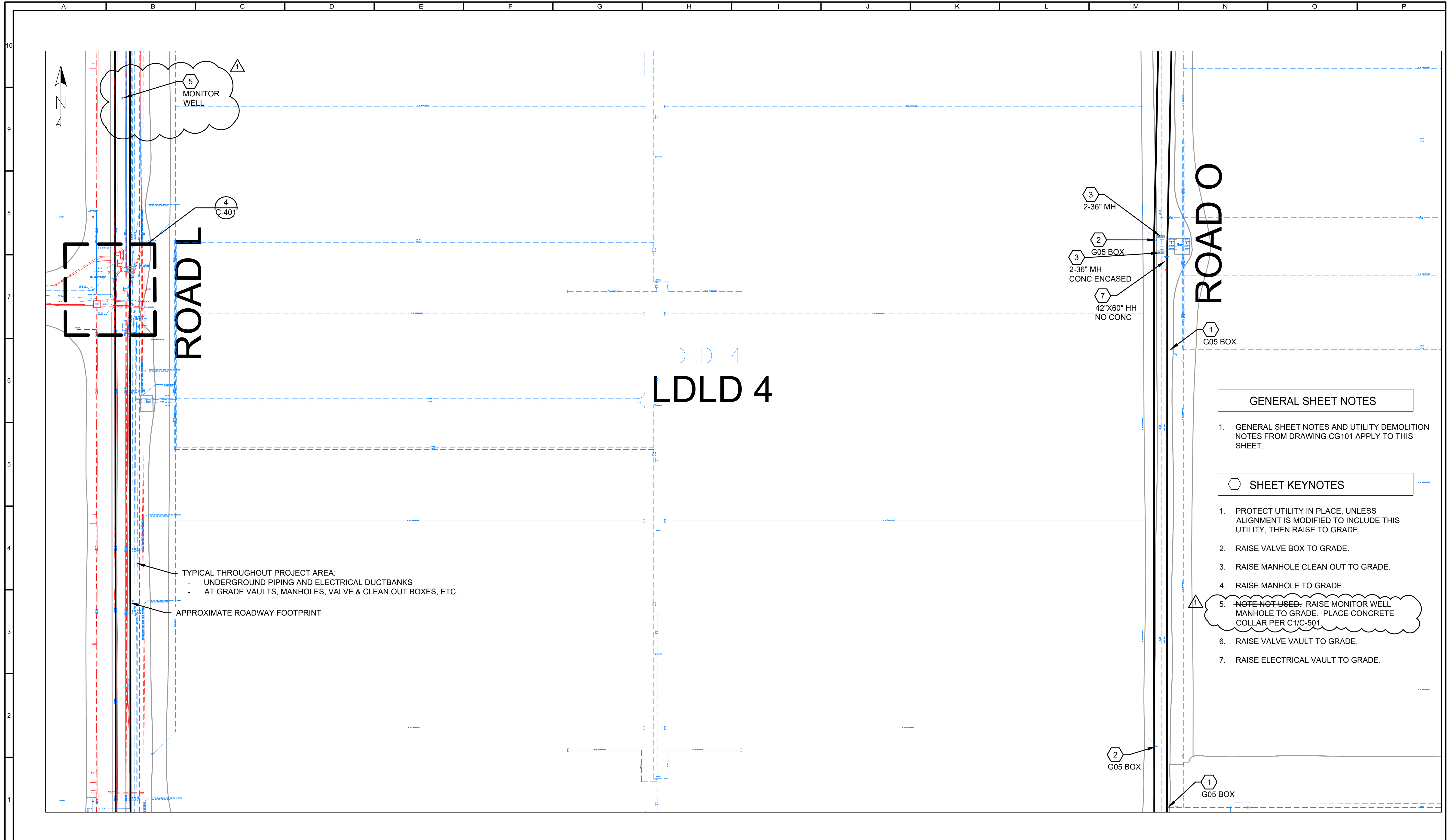

GENERAL SHEET NOTES

1. GENERAL SHEET NOTES AND UTILITY DEMOLITION NOTES FROM DRAWING CG101 APPLY TO THIS SHEET.

SHEET KEYNOTES

1. PROTECT UTILITY IN PLACE, UNLESS ALIGNMENT IS MODIFIED TO INCLUDE THIS UTILITY, THEN RAISE TO GRADE.
2. RAISE VALVE BOX TO GRADE.
3. RAISE MANHOLE CLEAN OUT TO GRADE.
4. RAISE MANHOLE TO GRADE.
5. ~~NOTE NOT USED-~~ RAISE MONITOR WELL MANHOLE TO GRADE. PLACE CONCRETE COLLAR PER C1/C-501.
6. RAISE VALVE VAULT TO GRADE.
7. RAISE ELECTRICAL VAULT TO GRADE.

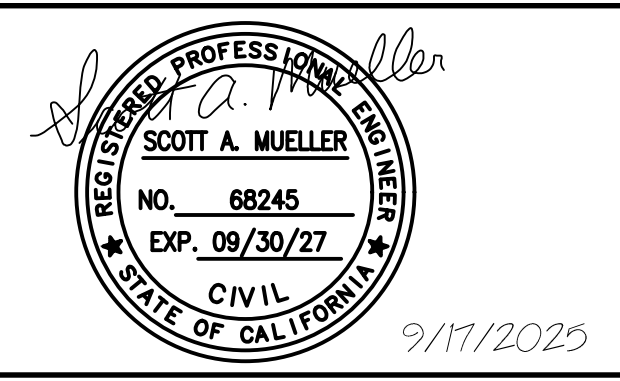

REVISIONS					
ZONE	REV.	DESCRIPTION	BY	DATE	APP.
	1	ADDENDUM #1		10/20/25	

LINE IS 2 INCHES AT FULL SIZE (IF NOT 2"-SCALE ACCORDINGLY)

FILE _____
 DRAWN SM
 DESIGNED SM
 CHECKED DTW

RFB 8517

SACRAMENTO AREA SEWER DISTRICT
 ECHOWATER RESOURCE RECOVERY FACILITY
 LDLD ROAD REHABILITATION PROJECT

CIVIL
 PLAN-UTILITIES AREA C

SCALE 1"=60'
 DRAWING NUMBER CG103
 SHEET NUMBER 10 OF 16

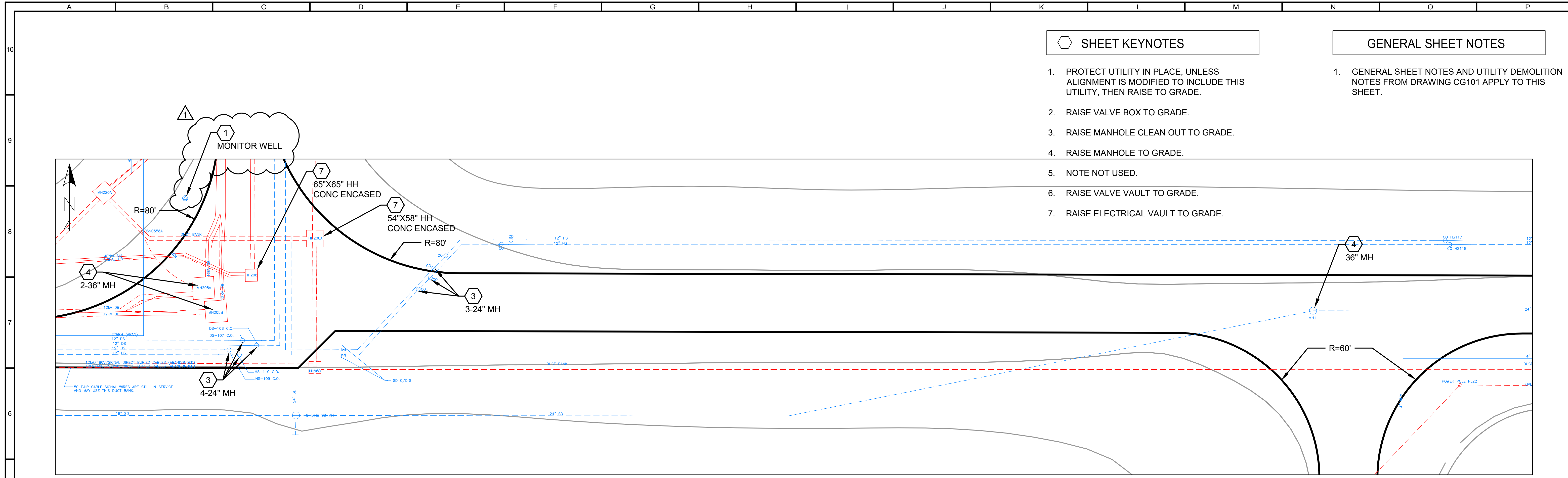

SHEET KEYNOTES

1. PROTECT UTILITY IN PLACE, UNLESS ALIGNMENT IS MODIFIED TO INCLUDE THIS UTILITY, THEN RAISE TO GRADE.
2. RAISE VALVE BOX TO GRADE.
3. RAISE MANHOLE CLEAN OUT TO GRADE.
4. RAISE MANHOLE TO GRADE.
5. NOTE NOT USED.
6. RAISE VALVE VAULT TO GRADE.
7. RAISE ELECTRICAL VAULT TO GRADE.

GENERAL SHEET NOTES

1. GENERAL SHEET NOTES AND UTILITY DEMOLITION NOTES FROM DRAWING CG101 APPLY TO THIS SHEET.

6 **DETAIL AREA 6**
CG104 SCALE 1"=20'

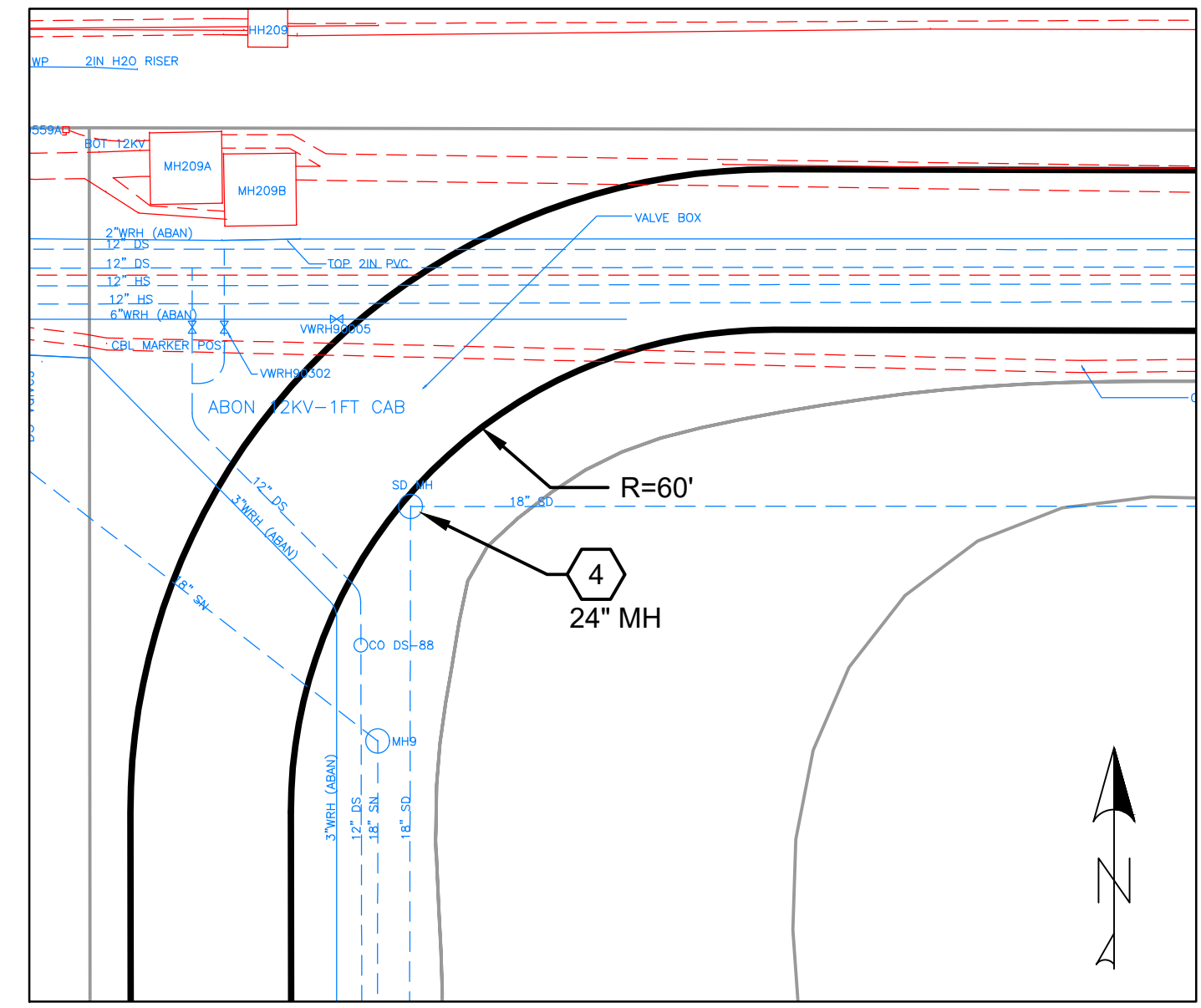

5 **DETAIL AREA 5**
CG105 SCALE 1"=20'

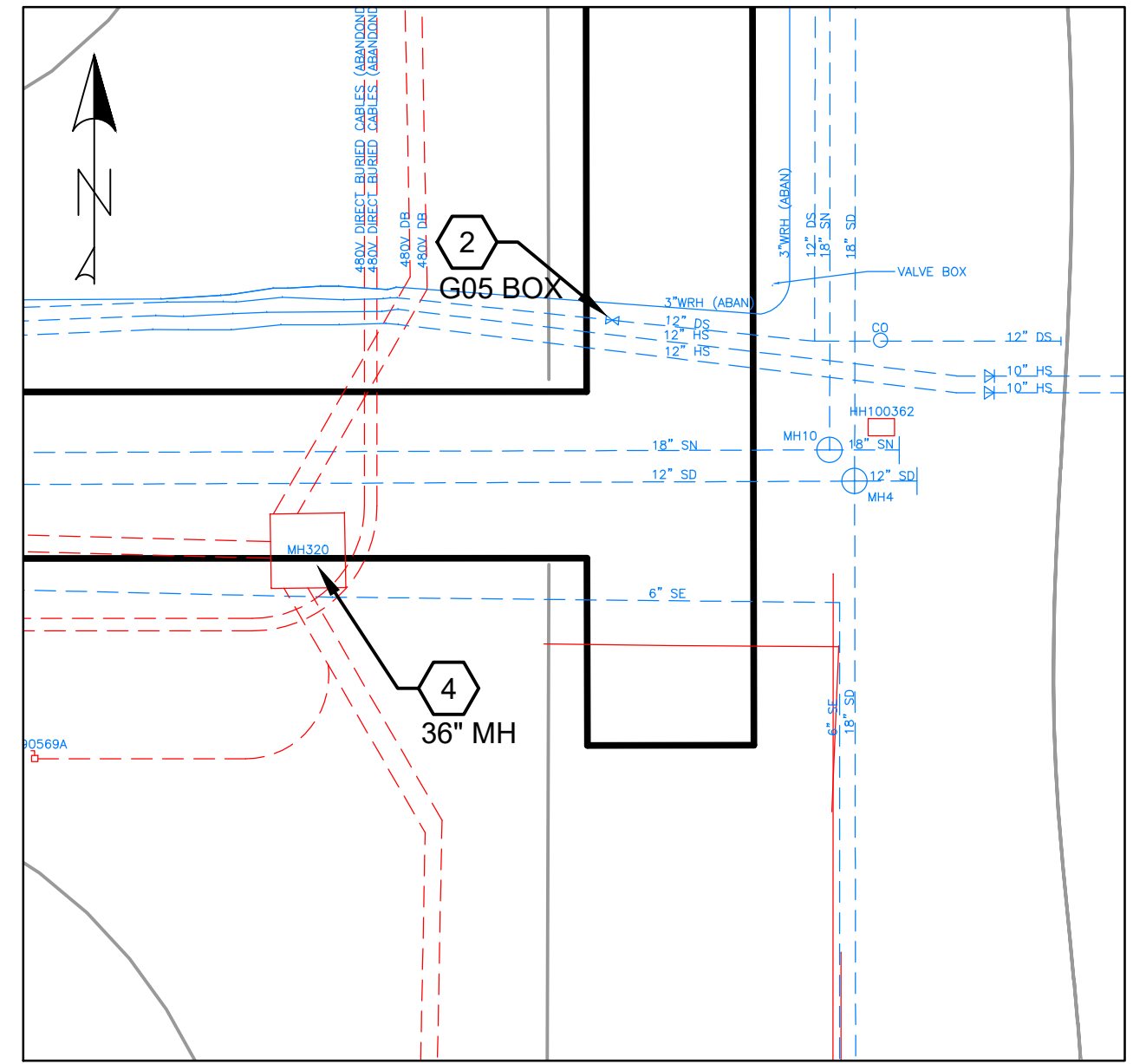

7 **DETAIL AREA 7**
CG105 SCALE 1"=20'

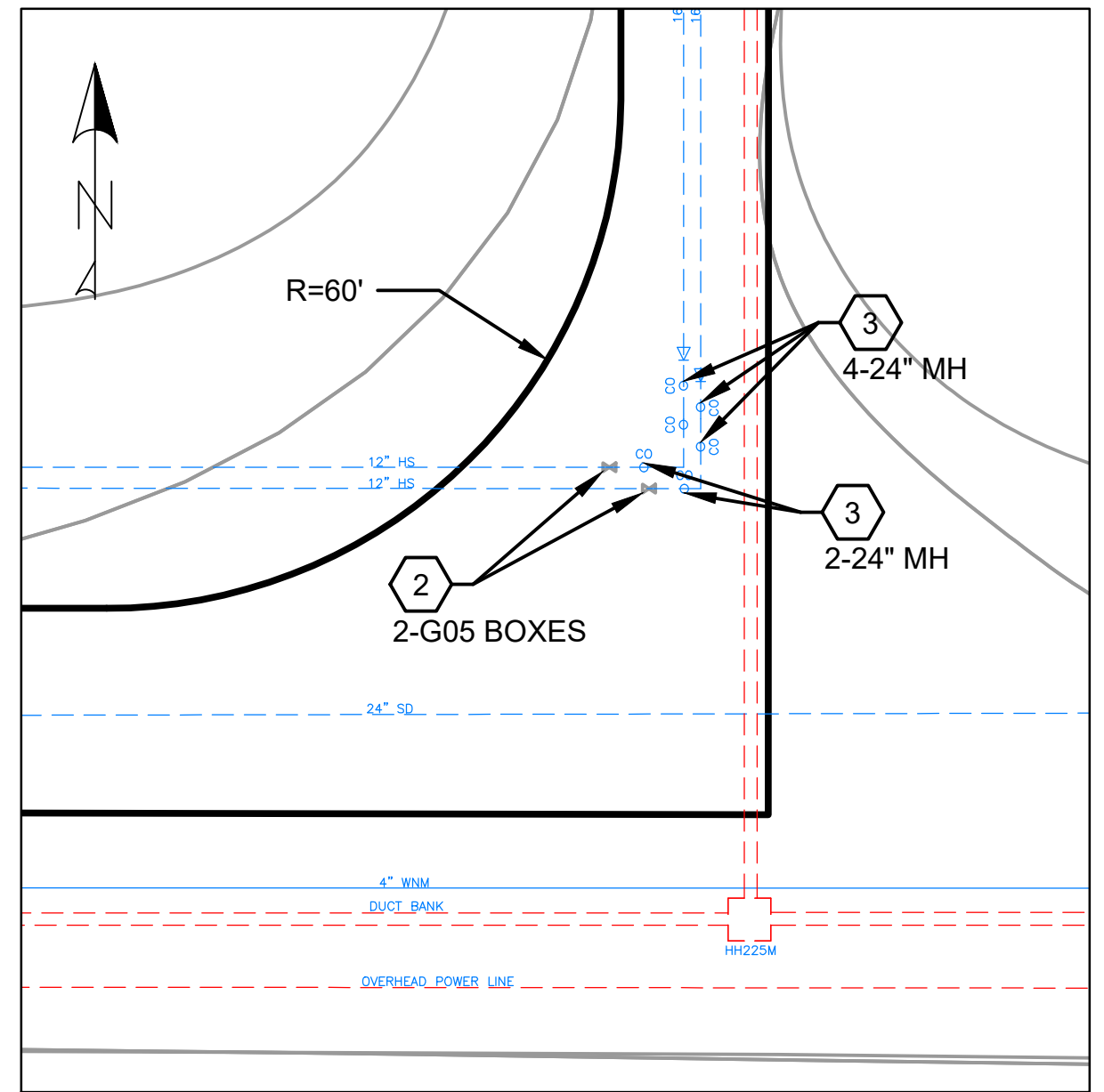

8 **DETAIL AREA 8**
CG104 SCALE 1"=20'

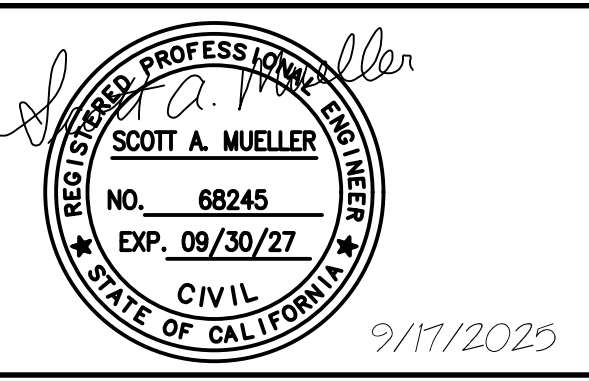

REVISIONS					
ZONE	REV.	DESCRIPTION	BY	DATE	APP.
	1	ADDENDUM #1		10/20/25	

LINE IS 2 INCHES AT FULL SIZE (IF NOT 2" SCALE ACCORDINGLY)

FILE _____
 DRAWN SM
 DESIGNED SM
 CHECKED DTW

RFB 8517

SACRAMENTO AREA SEWER DISTRICT

ECHOWATER RESOURCE RECOVERY FACILITY
 LLDL ROAD REHABILITATION PROJECT

CIVIL

INTERSECTION PARTIAL PLAN 2

SCALE AS SHOWN

DRAWING NUMBER C-402

SHEET NUMBER 15 OF 16