



CONTRACT DOCUMENTS FOR THE CONSTRUCTION OF  
**ECHOWATER RESOURCE RECOVERY FACILITY**

# **Septage Disposal Site - Paving & Concrete Improvements**

**Volume 2 of 2 - Drawings**

**RFB 8513**

# Site Map



**GENERAL NOTES:**

1. EXCAVATED MATERIAL CAN BE DISPOSED OF ONSITE AT DISTRICT SPOILS PILE SHOWN ON SITE MAP. COORDINATE EXACT LOCATION WITH DISTRICT REPRESENTATIVE.
2. SEE PAGE 2 FOR SCHEMATIC WORK DRAWING, PAGE 3 FOR PLAN VIEW DRAWING AND PORTLAND CEMENT CONCRETE WORK ON PAGE 4.
3. PER SACRAMENTO COUNTY STANDARD CONSTRUCTION SPECIFICATIONS, MATERIALS SHALL BE:
  - A. AGGREGATE BASE: CLASS 2
  - B. ASPHALT CONCRETE: 3/4" HMA

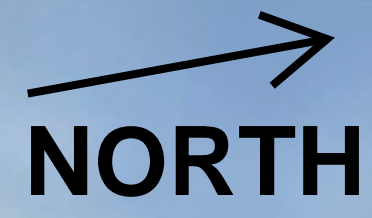

FOR REFERENCE, CONCRETE WORK LOCATION ON PAGE 4/4

EXISTING EP

5" AC ON 13" AB  
AREA = ~2,630 SF

2%

3' AB SHOULDER BACKING, 4" THICK

GRADE DRAINAGE SWALE TO FLOW SOUTHWEST

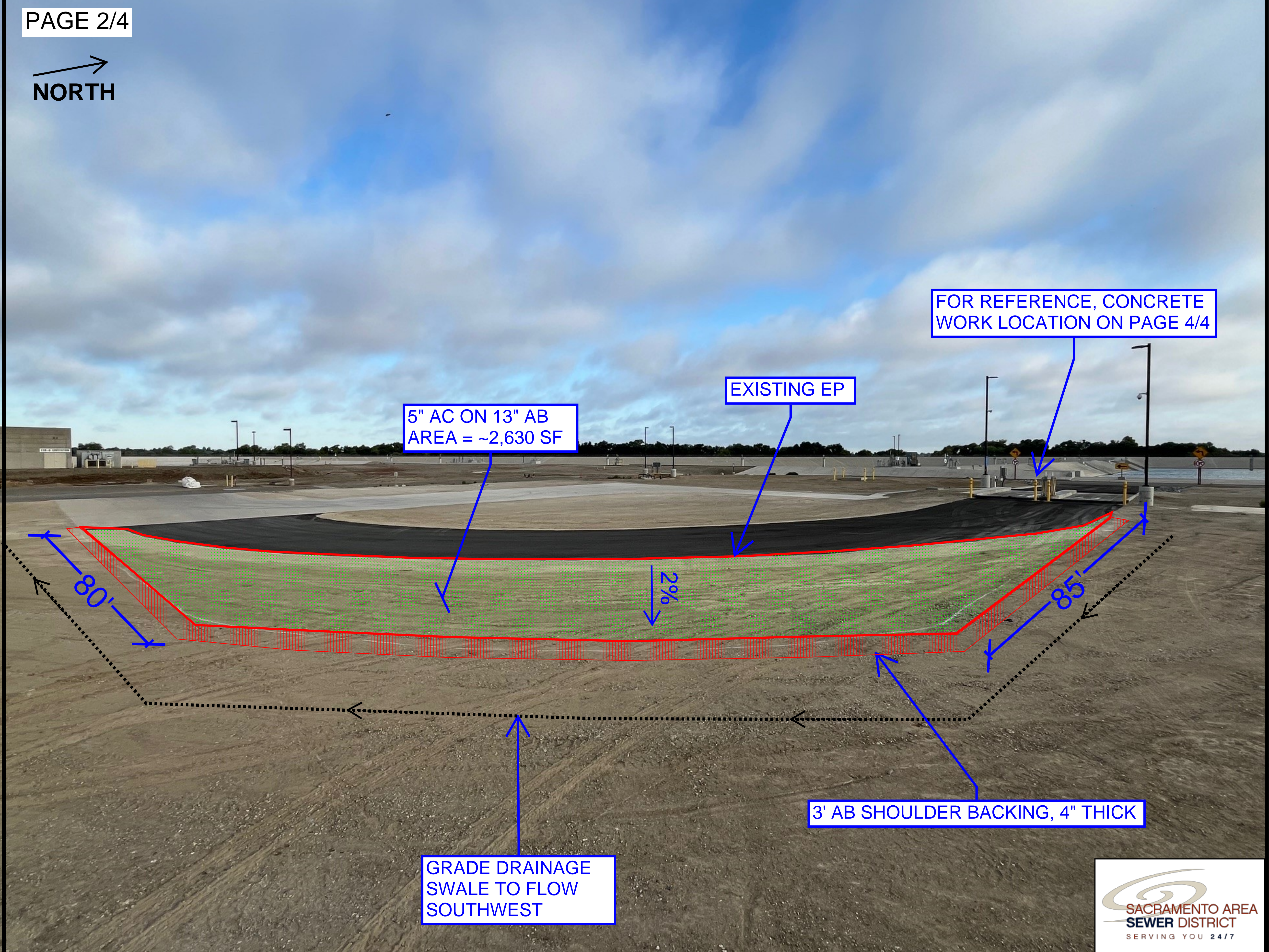

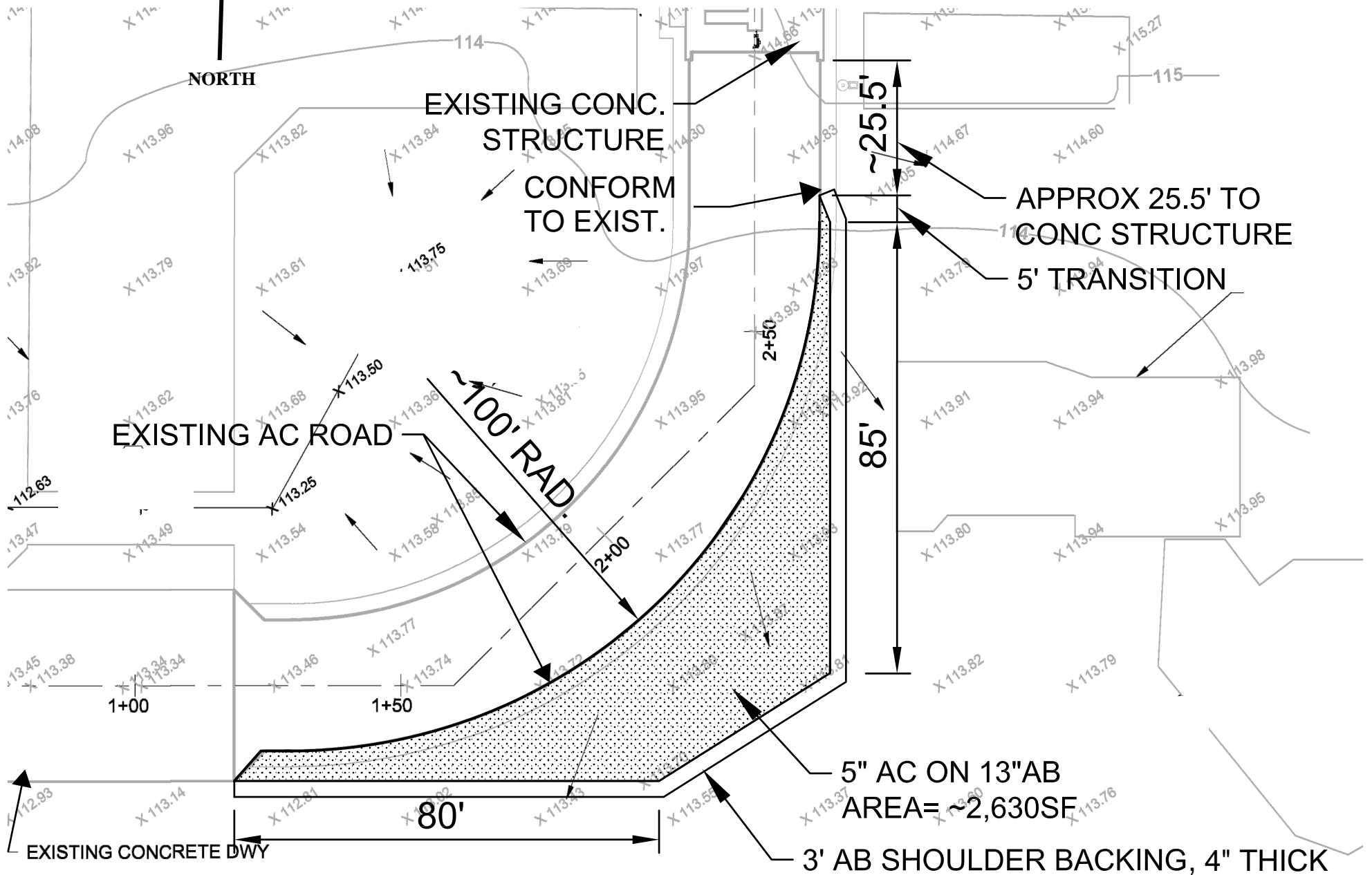

### AC PAVING PLAN VIEW

NO SCALE

DOWEL #4 REBAR INTO EXISTING CONCRETE @ 24" OC

REMOVE EXISTING MATERIAL TO RE-ESTABLISH DITCH FLOWLINE ADJACENT TO NEW CONCRETE. REUSE RIP-RAP TO LINE DITCH. GRADE TOWARDS ROADSIDE DITCH

PROTECT 1/2" THICK NEOPRENE PAD ON TOP OF PIPE OR REPLACE IF DAMAGED

EXISTING 12" RCP

ROADSIDE DITCH FLOWLINE

6"- 4,500 PSI CONCRETE W/#4 REBAR @12" OC/EW ON 4" AB @ 95% COMPACTION.

SAWCUT AC PRIOR TO CONCRETE PLACEMENT AS NEEDED FOR CLEAN CONCRETE EDGE

